

State of South Carolina 96 District (274)
East of the Indian Boundary line

Pursuant to warrant from John Thomas Esq. Commissioner of Location dated the 17th Nov 1784 I have admeasured and laid out unto David Morrow a tract of land containing one hundred acres lying on both sides of Dulermans Creek bounded to the East by John Eldor's land & to the N by Thomas Huneys land all other sides vacant land and hath such shape & marks as the annexed Plat represents Survey the 15th Sept 1784

Recorded the 24th Dec 1784 Geo: Thomson D.S.

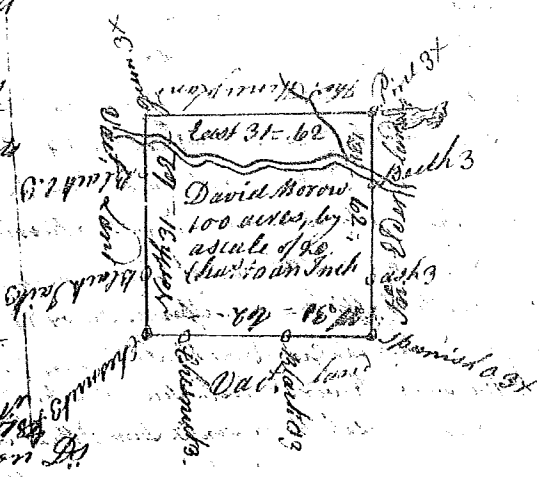

State of South Carolina 96 District Below the ancient Boundary
Pursuant to warrant from John Thomas Esq. Com. Loc. dated the 20th Nov 1784 I have admeasured & laid out unto London Farrow a tract of land containing one hundred acres lying on both sides of two miles creek bounded So. by Benjamin Kefford, W. by Neal Walden's Land all other sides vac. & hath such shape & marks as the annexed Plat represents Survey the 23rd Sept 1784

Recorded the 24th Dec 1784 Geo: Thomson D.S.

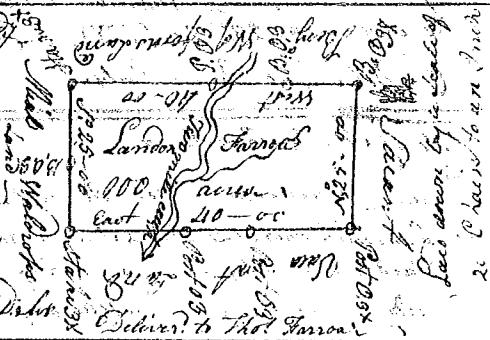

State of South Carolina 96 District Below the line

Pursuant to a warrant from John Thomas Esq. Com. Loc. dated the 9th Aug 1784 I have admeasured & laid out unto John Farrow a tract of land containing one hundred & forty acres lying on the East Branch of Enoree River bounded to the N by Thomas Farrow to the East by James Flandrau's to the North by Ebenezer Moses Land all other sides vacant land and hath such shape & marks as the annexed Plat represents Survey the 29th Sept 1784

Recorded the 24th day of Dec 1784 Geo: Thomson D.S.



State of S. Carolina

Pursuant to a warrant from John Thomas Esq. Com. of Location dated the 15th Nov 1784 I have admeasured & laid out unto John Bennett a tract of land containing four hundred & fifty acres situated in Ninety six District East of the Old Boundary on both sides of Jones fork of the Great River bounding E. on Mary Wood's on North side & on Vacant & Peter Lewis's New Hayfields and Vacant Land and hath such form and marks as the Annexed Plat represents Survey the 27th of Dec 1784

Recorded the 27th Dec 1784 Geo: Salmon D.S.
(Delivered to Geo. Salmon)

